



Easemore Road, Riverside Redditch B98 8HH

Offers In Region Of £365,000

🛏 2 🚿 2 🚪 1



A beautifully presented two double bedroom detached bungalow offered with an en-suite to the master bedroom, principal bathroom, well appointed kitchen/diner, good size lounge, generous off road parking, landscaped rear garden and situated in recently developed location of Riverside, Redditch.

****No Onward Chain****



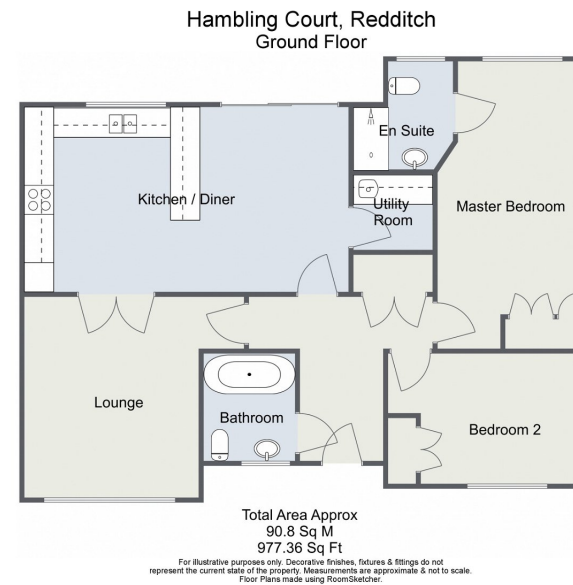

08/03/2023, 15:27

Energy performance certificate (EPC) - Find an energy certificate - GOV.UK

Energy performance certificate (EPC)		
4 Hambling Court Suttons Road Redditch B96 8PH	Energy rating B	Valid until: 19 June 2032 Certificate number: 2309-3004-1309-9133-1309
Property type: Detached bungalow		
Total floor area: 95 square metres		
Rules on letting this property Properties can be let if they have an energy rating from A to E. You can read guidance for landlords on the requirements and exemptions https://www.gov.uk/guidance/landlords-on-the-requirements-and-exemptions		

<https://find-energy-certificate.service.gov.uk/energy-certificate/2309-3004-1309-9133-1309/property>

1/8

For more information on this house or to arrange a viewing please call the office on:

01527 540 654

Alternatively, you can scan the QR to view all of the details of this property online.



arden
ESTATE AGENTS